

Parts List:

Part No:	Description:	Size:	Torque	Qty:
1	Crossbar			1
2	Coupling Packer			1
3	Bolt + Lockwasher + Flat Washer + Nut Retainer with Square T Nut	M12 x 45 x 1.75	80Nm	4
4	Bolt + Nyloc Nut + Flat Washer	M12 x 40 x 1.75	80Nm	2
5	Nut Insert Plate			2
6	Electrical Plate			1
7	Towball Bolt	M16 x 60	214Nm	2

Fitting:

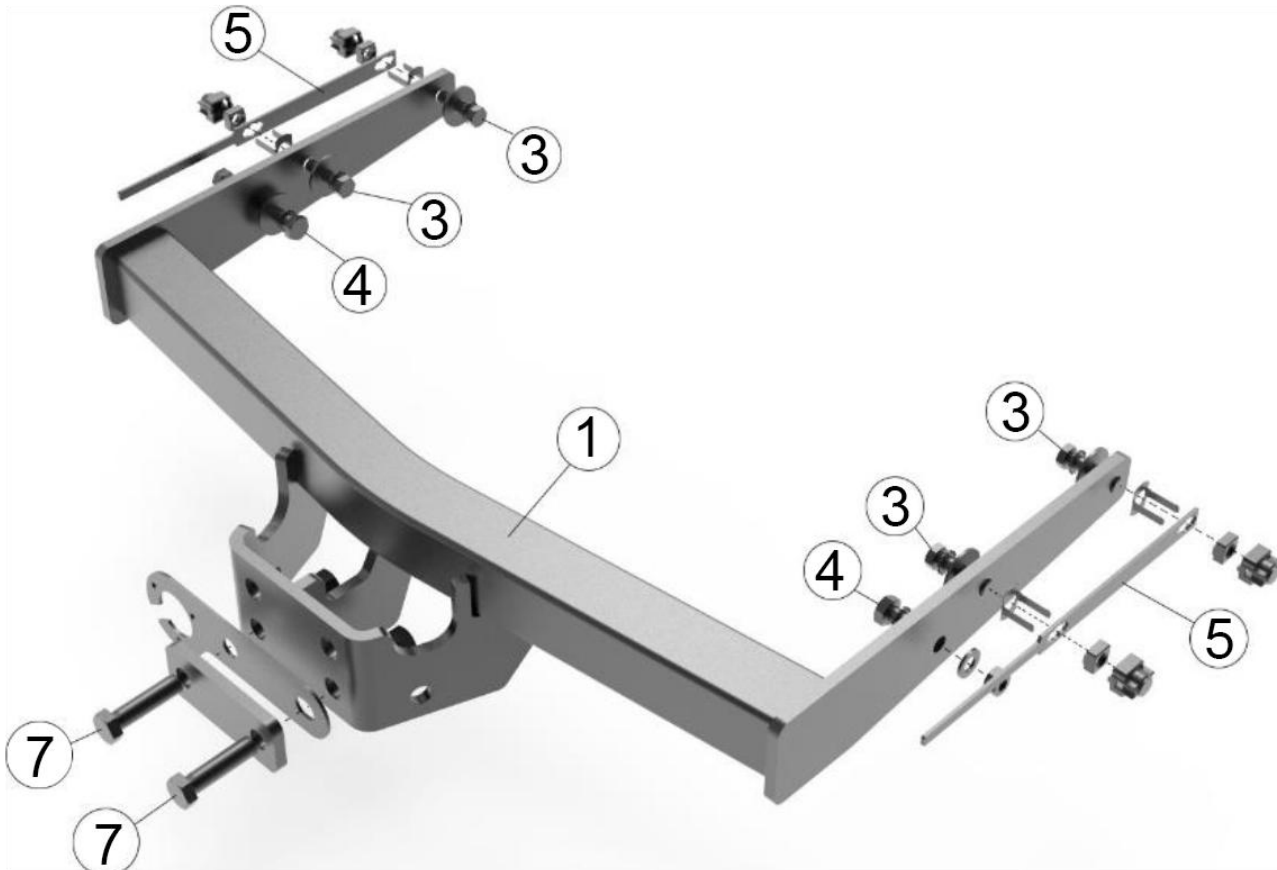

Fitting:

- Tailgate models only:** Remove rear light cluster and push in clips below. Remove the rear quarter panels beneath the light clusters to free the top of the bumper. **Twin Rear Door Models Only:** Remove the plastic cover below the door hinge and push in studs beneath. Remove the 2 torx head screws around each wheel arch, 1 behind arch trim and remove the push-in clips along the lower edge of the bumper. Then, remove the bumper from the vehicle.
- If metallic bumper beam installed: Remove and discard the bumper beam from the rear panel and refit the fitting bolts to the rear panel. If the plastic bumper beam is installed (T5 my. 2011 - I T6): Remove the bumper and cut according to the diagram (See reverse of this page). Refit plastic beam to rear panel.
- If fitted, remove the stiffeners inside the side rails. Lower the spare wheel / plastic under tray and locate the existing mounting holes in the chassis.
- Insert crossbar (1) inside the side rails and secure with the rear bolts (4).
- Assemble the cage nuts (3) to the Nut Insert Plates (5). Insert plates (5) inside the side rails and attach using bolts (3) with flat washers.
- Tighten all bolts to the recommended torque settings (See table above), being careful not to over tighten.
- Refit Bumper.
- Make a small cut to the plastic undertray using crossbar (1) as a guide and refit tray.
- Refit any parts removed in step 1

Note: This towbar must be used with a Class A50-1 or A50-X towball, which dimensionally conforms to A50-1 with a 'D' & 'S' value greater than or equal to that of the towbar.

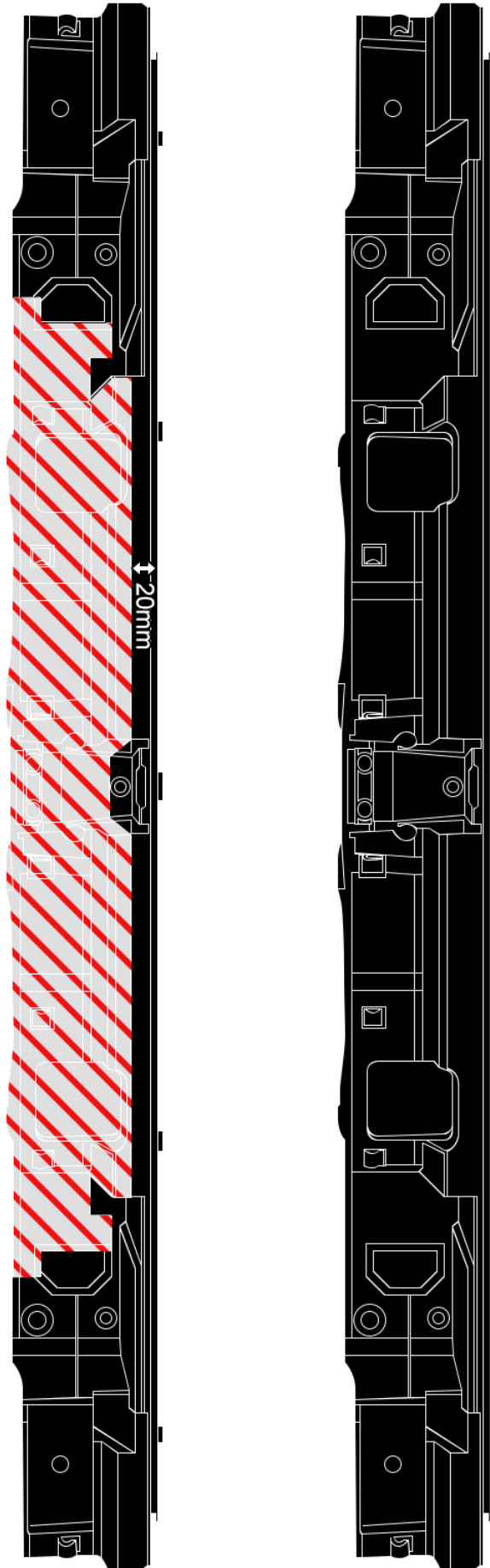

****Manufacturers towing limits must be observed for towing capacity****