

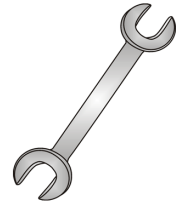

Tow-Trust Towbars

Important: Please read General Notes overleaf before fitting



Issue 8

TM4VK MERCEDES R-CLASS 2006>

Item	Qty	Description	Item	Qty	Description
A	1	Crossmember	D	2	M12 x 25 Bolts & S/P Washers
B	2	Handed Side Arms	E	4	M10 x 45 Bolts & S/P Washers
C	1	6207 Detachable Neck	F	4	M10 x 35 Bolts, Nuts & S/P Washers
			G	4	M10 Nuts & S/P Washers
			H	4	M12 x 45 Bolts & S/P Washers
			J	2	M12 x 40 Bolts & S/P Washers
			L	4	12 x 25 Flat Washers
			M	4	10 x 40 Flat Washers
			N	8	10 x 25 Flat Washers
			P	2	M12 x 22 Bolts & S/P Washers
			R	1	Flip Up Socket Plate (TTFP/LH)
			S	4	12 x 40 Flat Washers

1. Remove the rear bumper, three fixings in each wheel arch, four fixings on the lower edge, one tip fixing each side at the top of each wheel arch, two clips each side securing heat shield to bumper, one fixing inside the boot found in the lower corner by the light clusters.
2. Remove the bumper impact beam (This is not refitted with the Towbar) (NOTE: Inner top fixings are found under the boot floor trim).
3. Insert items B into each correct chassis and loosely fix in place using items E and items M.
4. Fix item A to the rear panel using items G with items N and items F with item N.
Always seal around the rear panel to prevent water ingress.
5. Using item J fix items B to item A.
6. Using items H with items S fix items B through the remaining fixing on item A.
7. Using items D with items L and item P with items L fix item C and item R to item A.
8. Fully tighten all nuts and bolts and ensure Towbar is rigid and secure.
9. Cut bumper **SEE SKETCH** and refit to vehicle.

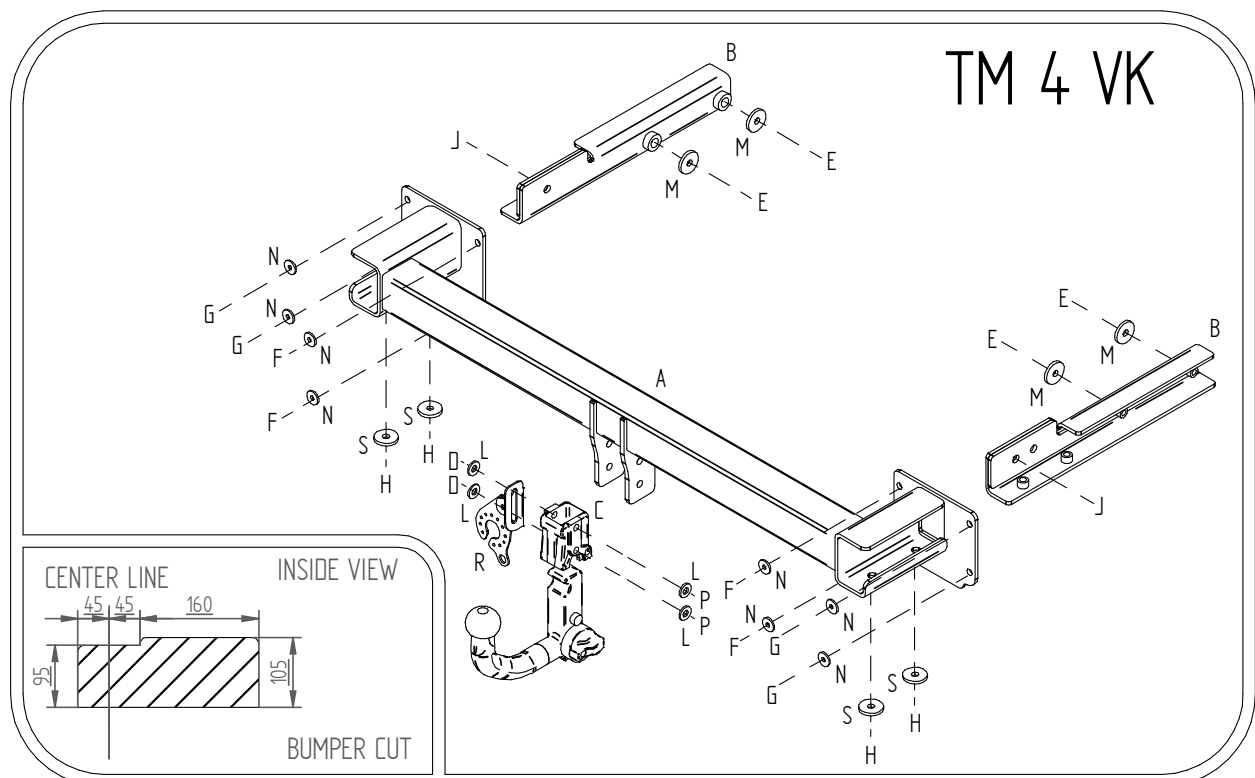

Note:

1. Torque Settings see notes overleaf.
2. Nose load limits and vehicle manufacturers trailer / caravan weight limits must be observed.