

FITTING INSTRUCTIONS

Transit Connect

TFO181 101068

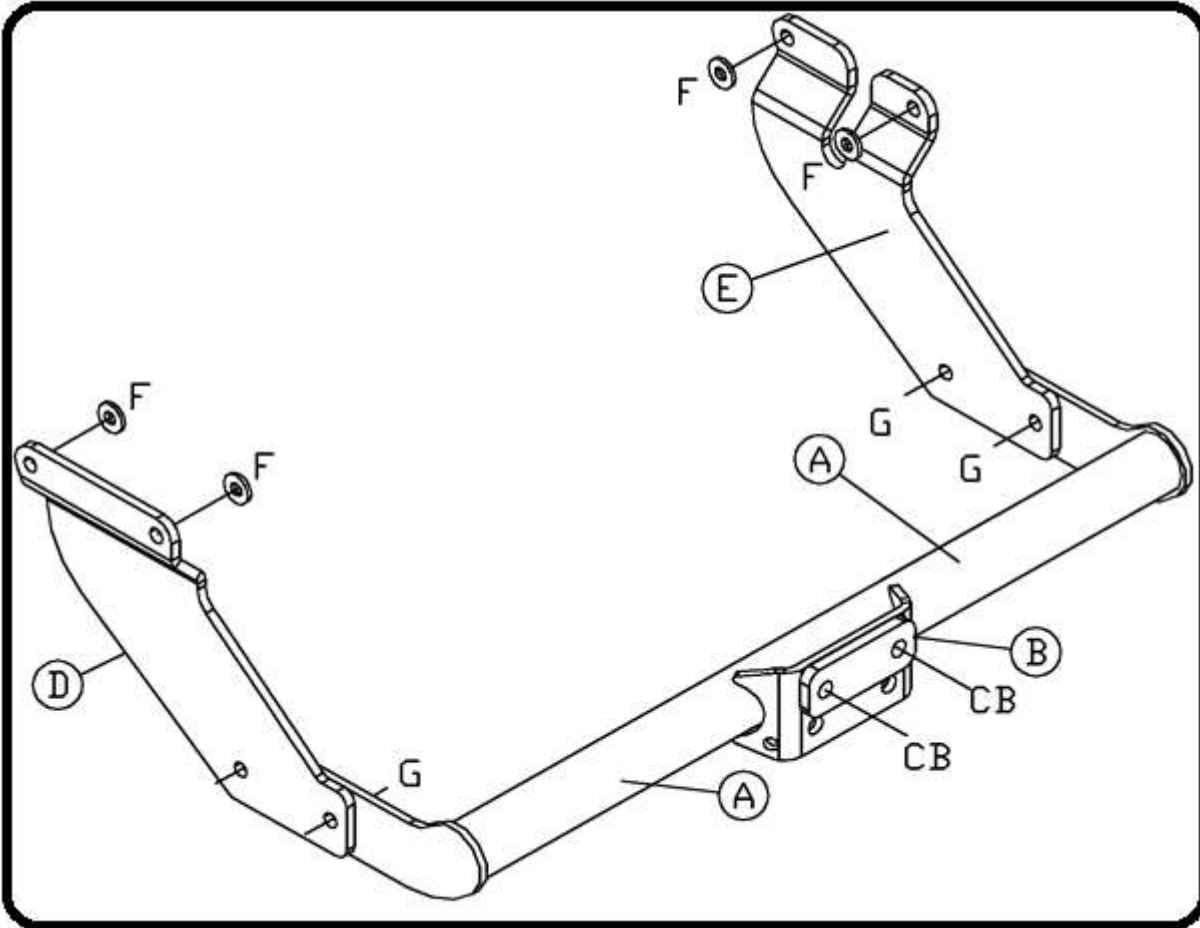

MATERIALS

A	1	Cross Bar
B	1	10mm Coupling Packer
	1	Rubber Pad
D	1	Left hand Side Mounting Plate
E	1	Right hand Side Mounting Plate
F	4	M12 x 1.75 x 50mm Bolts (10.9 Grade), Lock Washers and Flat Washers (30mm O.D.)
G	4	M12 x 1.75 x 35mm Bolts and Nyloc Nuts
CB	2	M16 x 50mm Coupling Bolts, Nuts, Lock Washers

FITTING

1. Lower spare wheel. Loosely attach Side Mounting Plates (D and E) to existing captive threads on the inboard face of chassis using Bolts (F) with Flat Washers as shown.
2. Loosely attach Cross Bar (A) to Side Mounting Plates (D and E) using Bolts (G) with Flat Washers. Ensuring Cross Bar (A) is pushed up towards bumper (to maintain exhaust clearance) fully tighten all bolts
- Note: Bolts (F) should be torqued to 139Nm. and raise spare wheel. On models fitted with a rear silencer box fit Rubber pad to Sidearm (D) to prevent contact.

Note: This towbar must be used with a Class A50-1 or A50-X towball, which dimensionally conforms to A50-1 with a 'D' and 'S' value greater than or equal to that of the towbar.

Recommended torque settings: Grade 8.8 bolts: M8 - 24Nm, M10 - 52 Nm, M12 - 80 Nm, M14 - 130 Nm, M16 - 200 Nm Grade 10.9: M12 - 120Nm, M10 - 70Nm M8- 35Nm